



22 Smeaton Court  
, Hertford, SG13 7AL  
Guide price £315,000

Icons representing property features: 2 bedrooms, 1 bathroom, 1 living area, and a kitchen (B).



# 22 Smeaton Court, Hertford, SG13 7AL

Greenhill Estates are delighted to present this beautifully appointed top floor two-bedroom modern apartment, boasting a private balcony with breathtaking panoramic views over the River Lea and the treetops of Hartham Park. Situated within walking distance of Hertford Town Centre, residents can enjoy an excellent selection of shops, cafes, bars, and restaurants, as well as convenient access to Hartham Park and Hertford East mainline station, offering direct links into London Liverpool Street and Tottenham Hale. The apartment itself offers a superb blend of style and space, featuring a bright and spacious lounge/diner, a contemporary high-spec kitchen with integrated appliances, a generous principal bedroom with fitted wardrobes, a second double bedroom, and a luxurious, fully tiled bathroom with a rainfall shower. Further benefits include a welcoming entrance hall, allocated underground parking, and beautifully maintained communal areas, making this an ideal home for professionals, downsizers, or investors alike.

This apartment is an ideal blend of style, space, and functionality—perfect for modern living.



Step Inside:

Location:



## Area Map

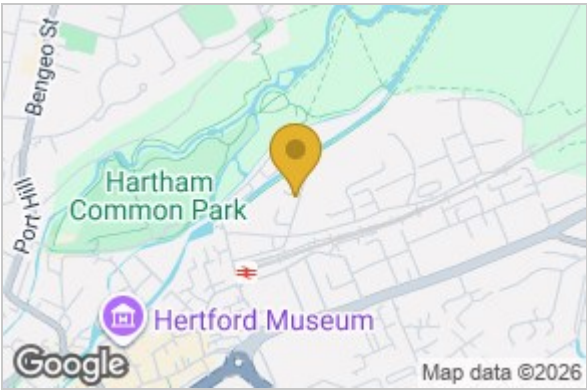

## Floor Plan

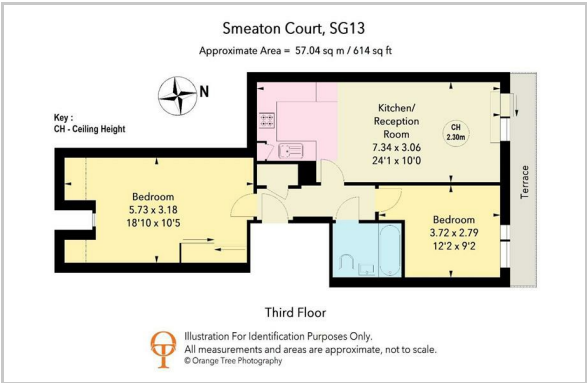

## Energy Efficiency Graph

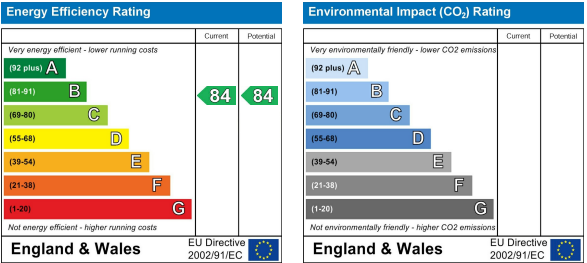

These particulars, whilst believed to be accurate are set out as a general outline only for guidance and do not constitute any part of an offer or contract. Intending purchasers should not rely on them as statements of representation of fact, but must satisfy themselves by inspection or otherwise as to their accuracy. No person in this firms employment has the authority to make or give any representation or warranty in respect of the property.

Sopers House Sopers Road, Cuffley, EN6 4RY  
Tel: 01707 802001 Email: [sales@greenhillestates.co.uk](mailto:sales@greenhillestates.co.uk) <https://www.greenhillestates.co.uk>